

C Series & SG Series Tighten Easy Pitch Screw and Ring

① Correct vs. Incorrect Easy Pitch Screws and Ring

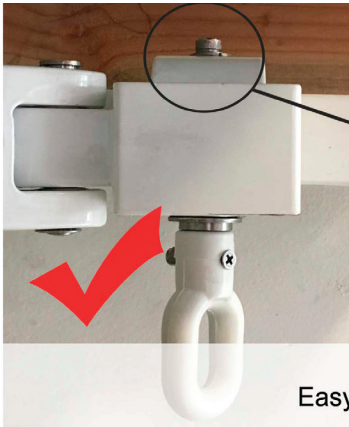

Correct
Easy Pitch Screws and Ring

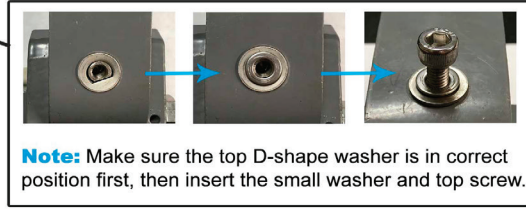

Note: Make sure the top D-shape washer is in correct position first, then insert the small washer and top screw.



Incorrect (Loose)
Easy Pitch Screws and Ring

- ② Retract the awning back to the fully closed position.
- ③ Position yourself under the awning (not in front of the awning/arms).

While making the adjustment, have an assistant help support/press the awning arm.

You will need a 5mm Short Arm Hex Key and a sturdy ladder.

- ④ Use a 5mm Hex Key to hold the top screw while tightening the Easy Pitch Loop.
- ⑤ Hold the tightened Easy Pitch steady, and use the hex key to tighten the top screw.

Secure the inner, outer arms and valance to the entire awning with ties or straps.
(Electric awnings: Please disconnect the power source)

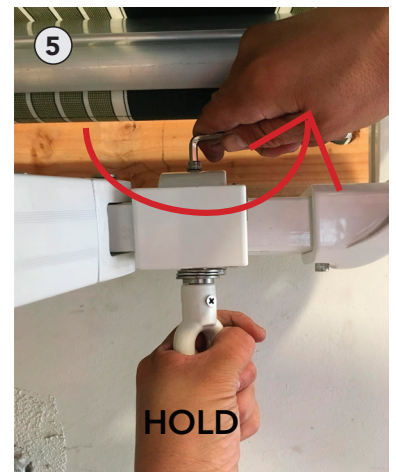
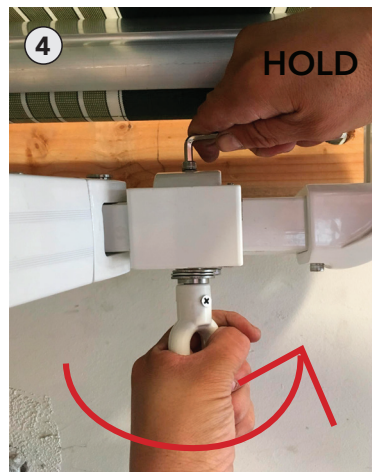
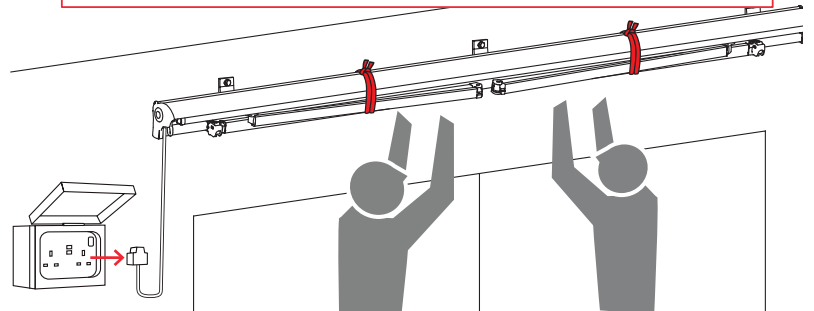

Our team prides itself on quality in product and service.

Should you have any concerns or questions, do not hesitate to reach us at service@advaning.com.